

CHECK VALVE with disc, with flanged ends

PN16 (1,6 MPa)	DN 15 - 300	a straight- way form	Fig. 287
PN25 (2,5 MPa)	DN 15 - 200		
PN40 (4,0 MPa)	DN 15 - 200		

APPLICATION

Industrial cold and hot water, steam, neutral fluids.

ADVANTAGES

- high tightness,
- compact construction,
- no maintenance,
- environment-friendly.

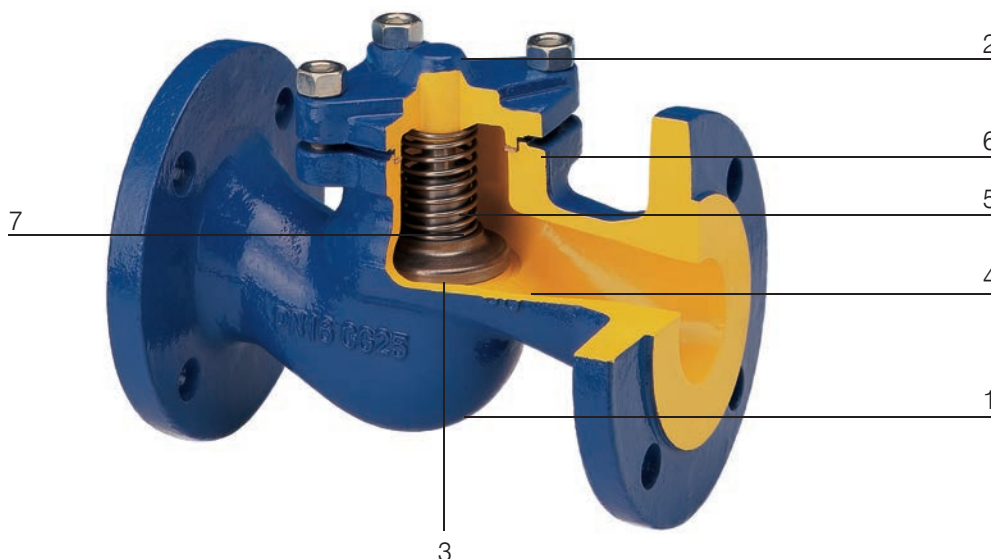

MATERIAŁY • WERKSTOFFE • MATERIALS

		Standard	Wykonania dodatkowe / Zusätzliche Ausführung / Additional design			
		Fig. 287A31 Fig. 288A31	Fig. 287C31	Fig. 287F31	Fig. 287A33 Fig. 288A33	Fig. 287E33
1.	Body	EN-GJL-250	EN-GJS-400-18-LT	GP240GH	EN-GJL-250	CuSn10-B
2.	Bonnet					
3.	Disc	X20Cr13 1.4021		St. nierdz. / Niro / St. Steel	CuSn10-B	
4.	Seat ring	X12Cr13 1.4006				
5.	Stem	X20Cr13 1.4021				
6.	Seal	Graphit - CrNiSt		Graphit	Graphit - CrNiSt	
7.	Spring	X17CrNi16-2 1.4057		St. nierdz. / Niro / St. Steel	CuSn6	
Max. working temperature		300°C	350°C	400°C	225°C	225°C
DN		15-300	15-200	15-200	15-300	15 - 50

Kadłub + pokrywa / Gehäuse + Deckel / Body + bonnet → A - EN-GJL-250, C - EN-GJS-400-18-LT, E - G-CuSn10, F - GPH240 GH

ASSEMBLING

Setting of valves without spring is recommended in a horizontal position, with the cover right up. Valves with springs may be mounted on vertical pipelines.

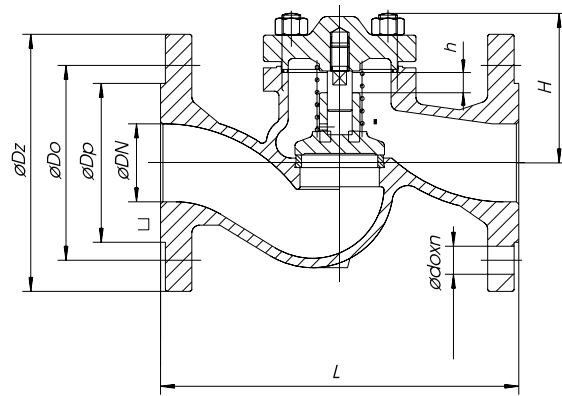

Fig. 287

Minimal pressure of the opening when the valve has got a spring

**0,05 - 0,1
bar**

Fig. 287A31	EN-GJL-250	PN16	DN 15-300	Fig. 288A31	EN-GJL-250	PN16	DN 15-300	Fig. 287A38	EN-GJL-250	PN16	DN 15-50
Fig. 287A33	EN-GJL-250	PN16	DN 15-300		Fig. 288A33	EN-GJL-250	PN16	DN 15-300	Fig. 288A38	EN-GJL-250	PN16
Fig. 287C31	EN-GLS-400-18-LT	PN16	DN 15-200	Fig. 287E33	CuSn10-B	PN16	DN 15-50	Fig. 287C38	EN-GLS-400-18-LT	PN16	DN 15-50
Fig. 287C33	EN-GLS-400-18-LT	PN16	DN 15-200								
Fig. 287C31	EN-GJS-400-18-LT	PN25	DN 15-200								
Fig. 287C33	EN-GJS-400-18-LT	PN25	DN 15-200								
Fig. 287E33	G-CuSn10-B	PN16	DN 15-50								
Fig. 287F31	GP240GH (1.0619)	PN40	DN 15-200								

Na życzenie klienta / Auf Wunsch der Kunden / On customer's request → Fig.288F DN15 - 200 na / für / for PN 40

DN	PN16, PN25, PN40		PN16				PN25				PN40			PN16, PN25				Fig.287A Fig.287C	Fig.288A	Fig.287F
	L	L1	Dz	Dp	Do	nxdo	Dz	Dp	Do	nxdo	Dz	Do	doxn	h	H	h1	H1			
mm																				
15	130	90	95	46	65	4x14	95	46	65	4x14	95	65	14x4	5	56	5	140	2,1	2,2	3,5
20	150	95	105	56	75	4x14	105	56	75	4x14	105	75	14x4	5	56	5	142	2,7	2,8	4,5
25	160	100	115	65	85	4x14	115	65	85	4x14	115	85	14x4	8	67	8	157	3,8	3,9	5,5
32	180	105	140	76	100	4x19	140	76	100	4x19	140	100	18x4	8	76	8	165	5,5	5,5	8
40	200	115	150	84	110	4x19	150	84	110	4x19	150	110	18x4	11	89	11	185	7,4	7,0	11
50	230	125	165	99	125	4x19	165	99	125	4x19	165	125	18x4	14	96	14	198	9,5	9,2	14
65	290	145	185	118	145	4x19	185	118	145	8x19	185	145	18x8	17	104	17	224	15,0	12,2	23
80	310	160	200	132	160	8x19	200	132	160	8x19	200	160	18x8	21	124	21	237	20,0	17,2	30
100	350	180	220	156	180	8x19	235	156	190	8x23	235	190	18x8	25	161	25	292	29,0	25,0	47
125	400	210	250	184	210	8x19	270	184	220	8x28	270	220	22x8	32	174	32	329	41,0	36,0	70
150	480	240	285	211	240	8x23	300	211	250	8x28	300	250	26x8	38	197	38	363	66,0	55,0	96
200	600	295	340	266	295	8x23	360	274	310	12x28	375	320	30x12	50	248	50	452	111	97,0	190
250	730	325	405	319	355	12x23	425	330	370	12x31	-	-	-	65	333	65	535	196	-	-
300	800	375	460	370	378	12x23	485	389	430	16x31	-	-	-	95	375	95	-	302	-	-

	PN16	PN25	PN40
Pressure test of the body	2,4 MPa	3,75 MPa	6,0 MPa
Pressure of the closure	1,76 MPa	2,75 MPa	4,4 MPa

Flanges	PN6, PN16 → EN 1092-2
---------	-----------------------

Face to face length	EN558-1 → 1-Fig. 287, 8-Fig.288 (DIN 3202 → F1-Fig. 287, F32-Fig.288)
---------------------	--

EN 1092 - 2 : 1997							
Pressure - temperature							
EN-GJL-250		EN-GLS-400-18-LT			GS-C25 (1.0619)		
PN16		PN16		PN16		PN40	
°C	bar	°C	bar	°C	bar	°C	bar
-10	16	-10	16	-10	25	-50	-
120	16	120	16	120	25	-20	40
150	14,4	150	15,5	150	24,3	120	40
180	13,4	200	14,7	200	23	200	35
200	12,8	250	13,9	250	21,8	250	32
230	11,8	300	12,8	300	20	300	28
250	11,2	350	11,2	350	17,5	350	24
300	9,6	-	-	-	-	400	21